

CABOS COM 120mm ± 5mm DE COMPRIMENTO

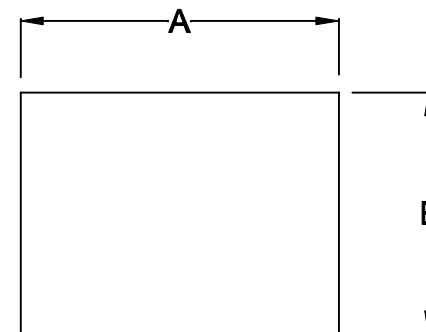
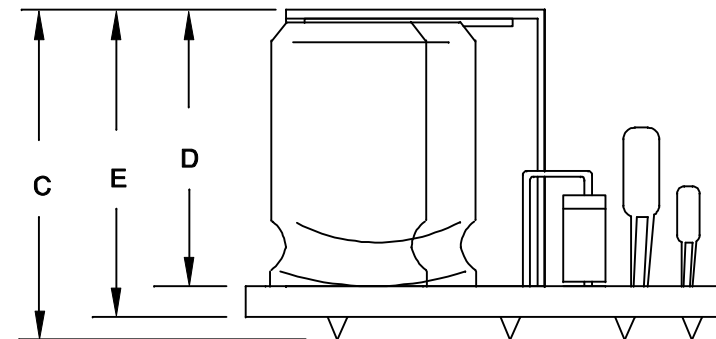
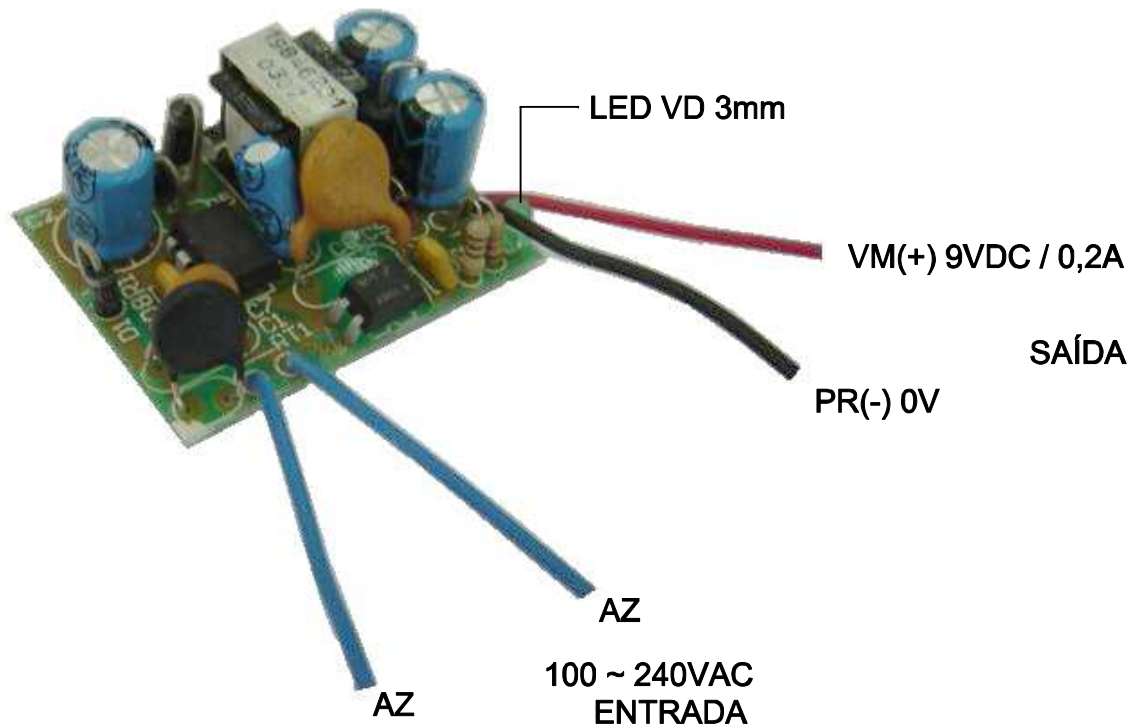

DIMENSÕES EM: [mm]

| A | B | C | D | E |
|----------|----------|---------|----------|---------|
| 41.5±0.5 | 31.5±0.5 | 18.6±.5 | 13.5±0.5 | 15.1±.5 |

PESO DO PRODUTO: 18,0 (g)

| | | | |
|---|----------|------------|------------|
|  TECNOTRAFO | | DOC. Nº | 108 |
| DIAGRAMA DE LIGAÇÃO | | | |
| CLIENTE | | TECNOTRAFO | |
| DESCRIÇÃO | | CODIGO | 134.875.01 |
| FONTE AC/DC E.100~240VAC S.9VDC/0,2A | | PLACA | B-208 |
| | | REV. | 01 |
| DATA: | 14/06/10 | AUTOR: | HIKISON |
| | | CONFERIDO: | |
| | | EMISSÃO | 04 |